

#6 Ground Lug, GL6STRI138

General Specification		Crimping Selections			
Material	Copper	Manufacturer	Die Color	Die Code	Tools Name
Finish	Tinned	T&B	Blue	24	TBM6, TBM8 TBM6H, TBM14BSCR
Color Code	Blue	Panduit	Blue	P24	CT-720, CT-1700 CT-920, CT-2001
Compliance	ANSI C119.4 Class A and UL/CUL486A	Burndy	Blue	7	Y1MR, Y2MR Y45, Y46

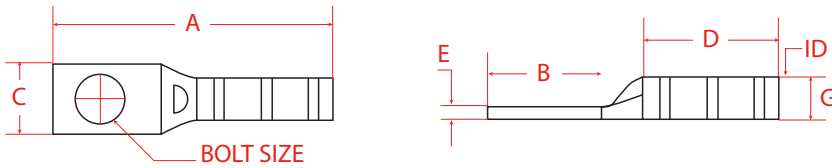

Dimensions						
A	B	C	D	E	F	G
2.11"	0.84"	0.62"	1.07"	0.08"	----	0.22"

Specifications						
Part #	Wire Size	Wire Type	Inspection Window	# of Bolt Holes	Bolt Size	Long or Short Barrel
GL6STRI138	6	Stranded	Yes	1	3/8"	Long

Part Number Description

Wire Size
Window
Hole Spacing

GL 6 STR I 1 38

Ground Lug
Wire Type
of Holes

